



ALPHANUMERIC PAGER

### FEATURES

- 3 different alert modes for incoming messages – Audio, Silent, Vibrate
- Maximum 20 private messages held in inbox\*
- Maximum 8 private message lock-ups
- 10 different ring tones
- Messages can contain up to 4 lines of 15-20 characters each
- Alarm function
- Back-lit function

### On/Off

To turn pager on, hold down the red-dot key for 2 seconds until the screen lights up.



To turn pager off, (1) press the red-dot key to display the menu screen, (2) press the left-arrow key once to highlight the Power Off symbol  then (3) press the green-line key. The screen will go blank.

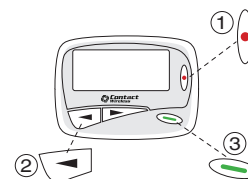

### Retrieving Messages

To read a message, (1) press the green-line key to display the initial screen, (2) press the green-line key again to display the read-message screen. (3) Press the green-line key again to read the message.

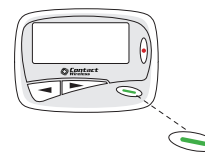

To move to another message, from the read-message screen press the arrow keys until the message you wish to read is displayed. Press the green-line key to read the message

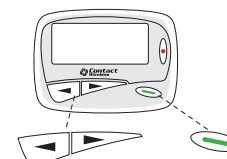

### Deleting Messages

To delete a single message, follow the instructions for retrieving a message. You must read the message before you can delete it. Once you have selected the message you wish to delete, hold down the green-line key until 5 icons appear at the bottom of the screen. Press the right-arrow key twice to highlight  Press the green-line key again to delete the message.

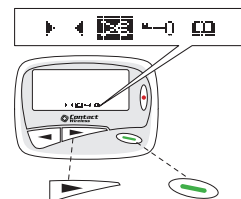

If you choose not to delete the message at this point, press the red-dot key to exit.

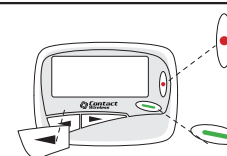

To delete all your messages, press the red-dot key to display the menu screen. Press the left-arrow key 3x to highlight  and press the green-line key. You will be asked if you would like to "Delete All?" press the green-line key again to select N or the right-arrow key once, then the green-line key to select Y.



### Locking/Unlocking Messages

To lock a message, follow the instructions for retrieving a message. You must read the message before you can lock it. Once you have selected the message you wish to lock, hold down the green-line key until 5 icons appear at the bottom of the screen. Press the right-arrow key 3x to highlight  and press the green-line key to confirm.  will appear in the top right corner to signify your message is locked.

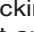
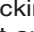
To unlock a message, follow the instructions for locking a message.  will appear with the 5 icons at the bottom of the screen. Press the right-arrow key 3x to highlight  and press the green-line key to confirm.

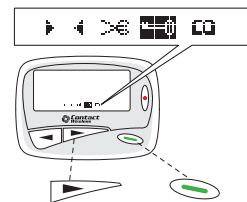

### Storing Messages In Notebook

To move a message to Notebook, follow the instructions for retrieving a message. You must read the message before you can move it to Notebook. Once you have selected the message you wish to move, hold down the green-line key until 5 icons appear at the bottom of the screen. Press the left-arrow key once to highlight  and press the green-line key to confirm.

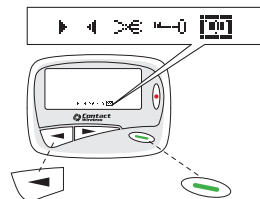

### Retrieving Messages In Mail Drop

To read a message in Mail Drop, press the green-line key to display the initial screen. Press the right-arrow key twice to highlight , and press the green-line key to confirm. Press the arrow keys and then press the green-line key to read the contents of the respective items.

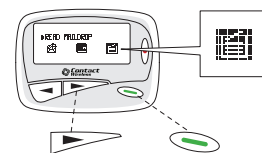

### Setting / Changing Alert Modes and Ring Tones

To change the alert mode, press the red-dot key to display the menu screen.  will be highlighted. Press the green-line key to select:

 Audio mode    Vibration mode    Silent mode    Buzzer alert mode

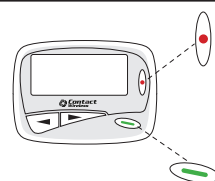

To change the ring tone, press the red-dot key to display the menu screen. Press the arrows keys until  is highlighted. Press the green-line key to view the selection of ring tones. Press the arrow keys to highlight desired ring tone. Press the green-line key to hear the ring tone you selected or press the red-dot key to exit.

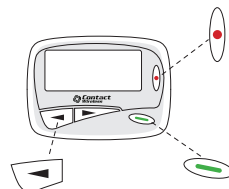

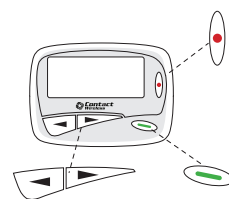

### Setting Time and Date

To set the time and date, press the red-dot key to display the menu screen. Press the arrow keys until  is highlighted, and press the green-line key to select. Press the green-line key to highlight the hour, minute, year, date or month and press the arrow keys to adjust the setting. Press the red-dot key to exit.

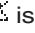
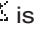
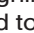
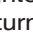

### Setting Alarm

To set the alarm, press the red-dot key to display the menu screen. Press the arrow keys until  is highlighted, and press the green-line key to select. Press the arrow keys while  is highlighted to turn the alarm on  or off . Press the green-line key to highlight the  hour and minute and press the arrow keys to adjust the setting. Press the red-dot key to exit.

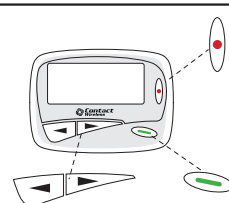

\* This pager is able to store 20 messages at a time. Once 20 messages have been stored, the pager will begin to automatically delete messages beginning with the oldest message as new pages are delivered. The pager will not delete messages that have been locked or stored in Notebook.